

CERTIFICATE OF MONUMENT LOCATION

CITY MON. NO. 0051

OLD INDEX NO. 0013

SEC Corner in the NE Qtr. of Section 26 Township 29 Range 23

STATE OF MINNESOTA, County of Ramsey

At the corner location shown on the sketch:

On OCT. 24. 2011 found a CIM BROKEN OFF DURING STREET
date
RE-PAVING E E DALE ST & MARYLAND

- left monument as found
 lowered monument
 removed monument (explain)
REPLACED, SET NEW CIM IN CONCRETE

On OCT. 24. 2011 placed X TIES - PHOTOS 2' TIES (SMALL MAGNILES)
date

SKETCH OF REFERENCE TIES

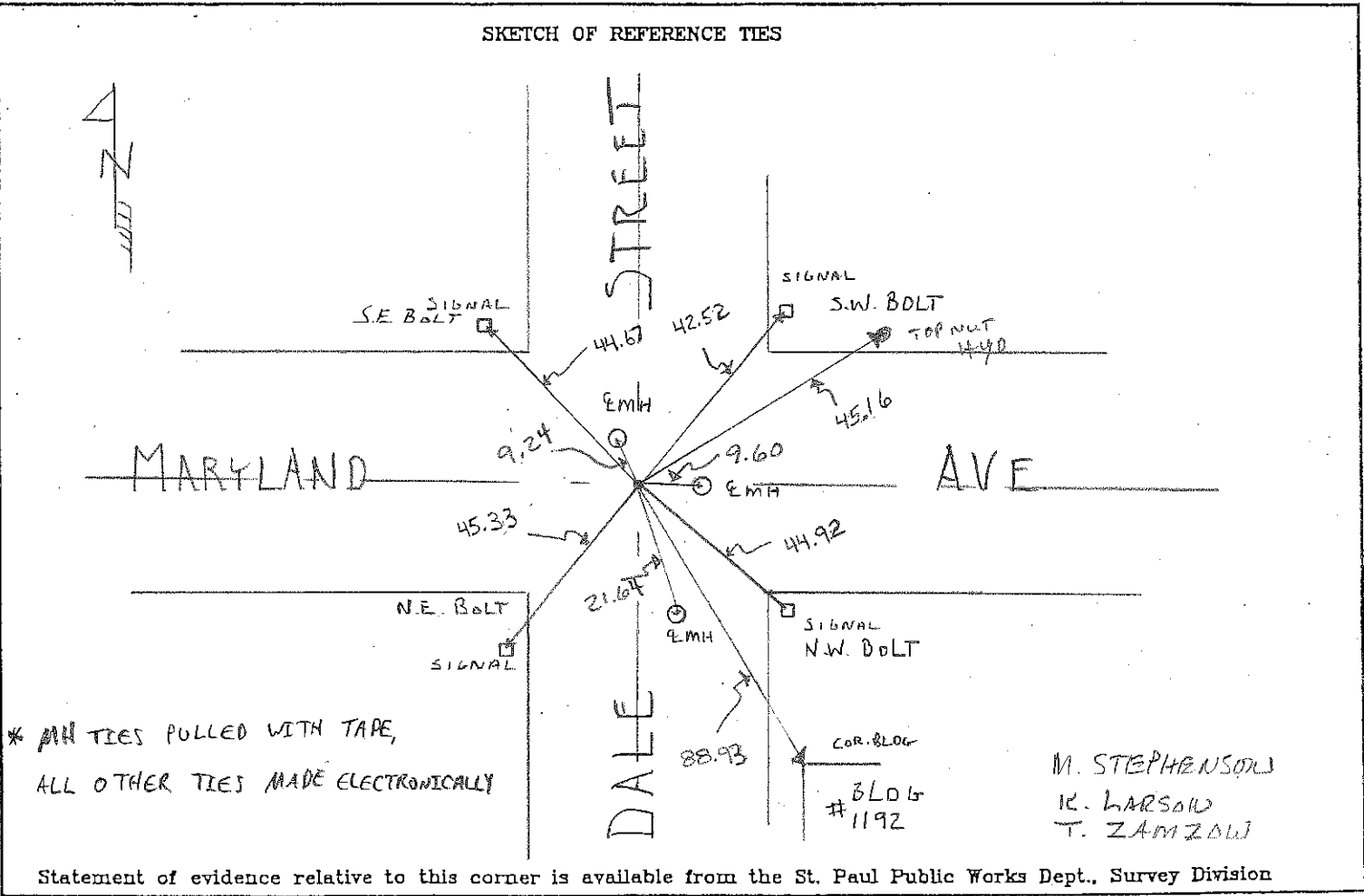

I hereby certify that this document and the data contained herein was prepared by me or under my direct supervision.

[Signature] Aug 17, 2012
SIGNATURE DATE

- Registration No. 44880
- Land Surveyor
 County Surveyor
 Professional Engineer
 Chief Surveyor, City of St. Paul

Office of The County Recorder, County of Ramsey

I hereby certify that this document was filed in the county

Recorders office at _____ M. on the _____ day of _____

County Recorder _____

By _____, Deputy

DOCUMENT NUMBER _____