

# CERTIFICATE OF MONUMENT LOCATION

City ID: 0733

Old Index #: 2190

NNW 1/16 Corner of Section 26 Township 29 Range 22, 4th P.M.

STATE OF MINNESOTA, County of Ramsey

At the corner location shown on the sketch:

On Sept 18, 2012 found a 1" diameter iron pin at street grade.

left monument as found       lowered monument       removed monument (explain)

On \_\_\_\_\_ placed a \_\_\_\_\_

SKETCH OF REFERENCE TIES

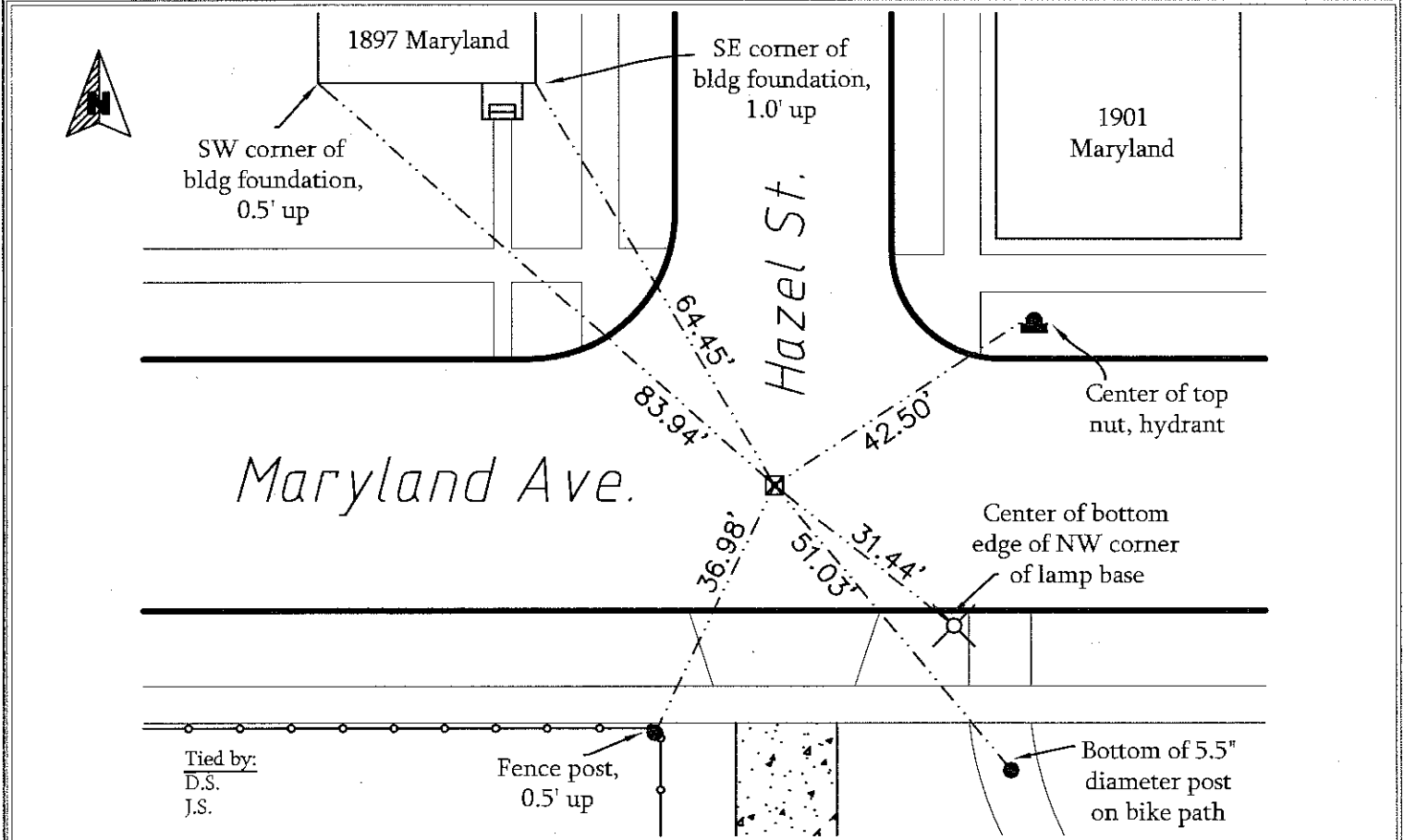

Tied by:  
D.S.  
J.S.

Fence post,  
0.5' up

Bottom of 5.5"  
diameter post  
on bike path

Statement of evidence relative to this corner is available from the St. Paul Public Works Dept., Survey Division

I hereby certify that this document and the data contained herein was prepared by me or under my direct supervision.

*[Signature]*  
Dec 24, 2012

Registration No. 44880

- Land Surveyor       County Surveyor
- Professional Engineer
- Chief Surveyor, City of St. Paul

Office of the County Recorder, County of Ramsey  
I hereby certify that this document was filed in the county recorders office at \_\_\_\_\_ M. on the \_\_\_\_\_ day of \_\_\_\_\_

County Recorder \_\_\_\_\_

By \_\_\_\_\_, Deputy

DOCUMENT NUMBER \_\_\_\_\_