

CERTIFICATE OF MONUMENT LOCATION

CITY MON. NO. 2373

OLD INDEX NO. ka

Corner in the NW Qtr. of Section 33 Township 29 Range 23

STATE OF MINNESOTA, County of Ramsey

At the corner location shown on the sketch:

On DEC. 26, 2012 found a LIM .35 BELOW ASPHALT GRADE

date

LIM IS WITNESS CORNER 3.7' NORTH OF MONT. 108 (CLEVELAND AND UNIVERSITY AVE. PRODUCED)

- left monument as found
- lowered monument
- removed monument (explain)

On DEC. 26, 2012 placed TIES - PHOTOS

date

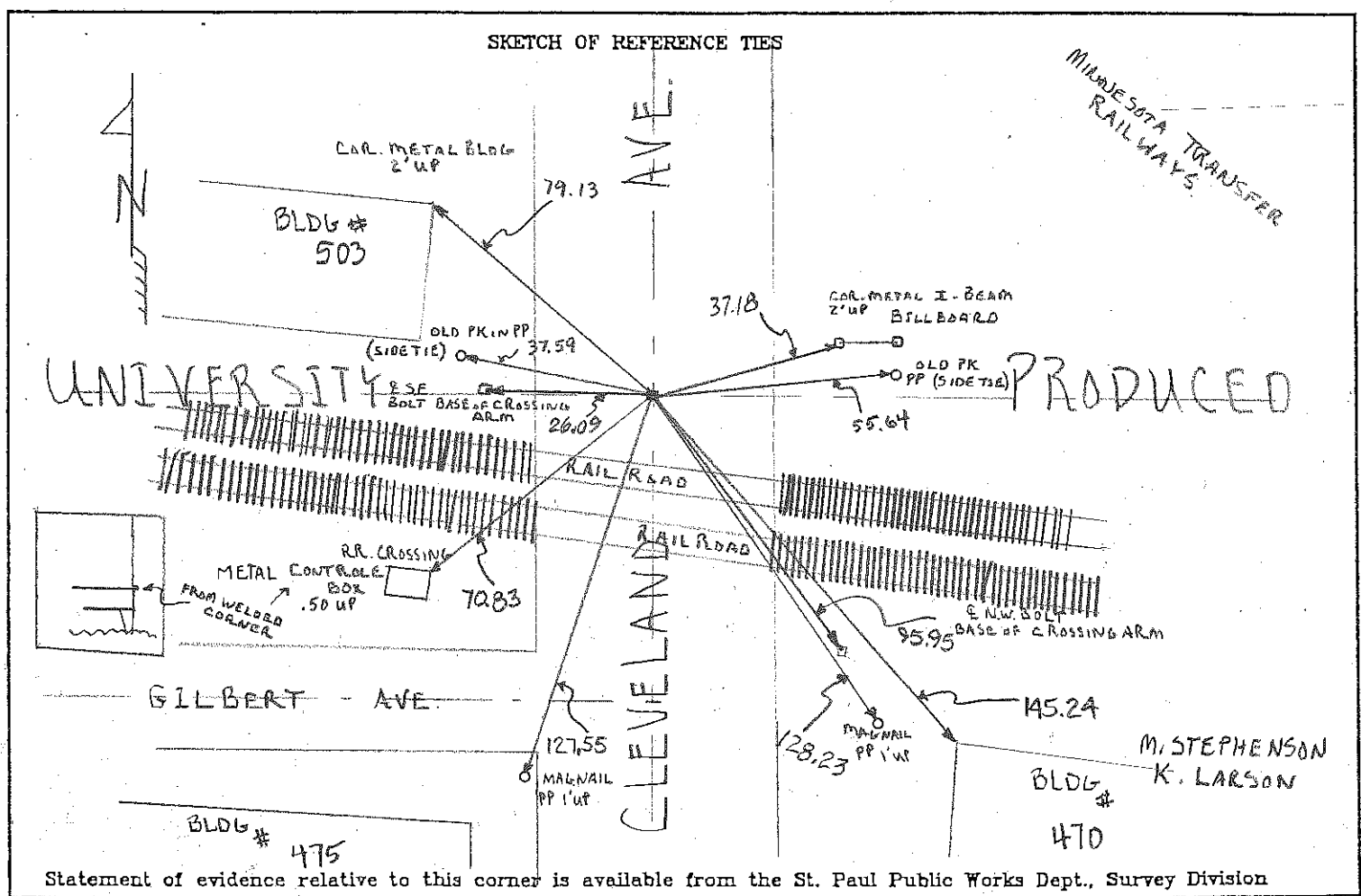

I hereby certify that this document and the data contained herein was prepared by me or under my direct supervision.

[Signature]

JAN 2, 2013

SIGNATURE

DATE

Registration No. _____

- Land Surveyor
- County Surveyor
- Professional Engineer
- Chief Surveyor, City of St. Paul

Office of The County Recorder, County of Ramsey

I hereby certify that this document was filed in the county Recorders office at _____ M. on the _____ day of _____

County Recorder _____

By _____, Deputy

DOCUMENT NUMBER _____