

CERTIFICATE OF MONUMENT LOCATION

CITY MON. NO. 3824

OLD INDEX NO. 0864A

BLK Corner in the NW Qtr. of Section 4 Township 28 Range 23

STATE OF MINNESOTA, County of Ramsey

At the corner location shown on the sketch:

On NOV. 29. 2012 found a GM BLK CORNER .10 BELOW SIDEWALK GRADE
date

NEC DAYTON AVE & CLEVELAND AVE.

left monument as found lowered monument removed monument (explain)

On NOV. 29. 2012 placed & TIES
date

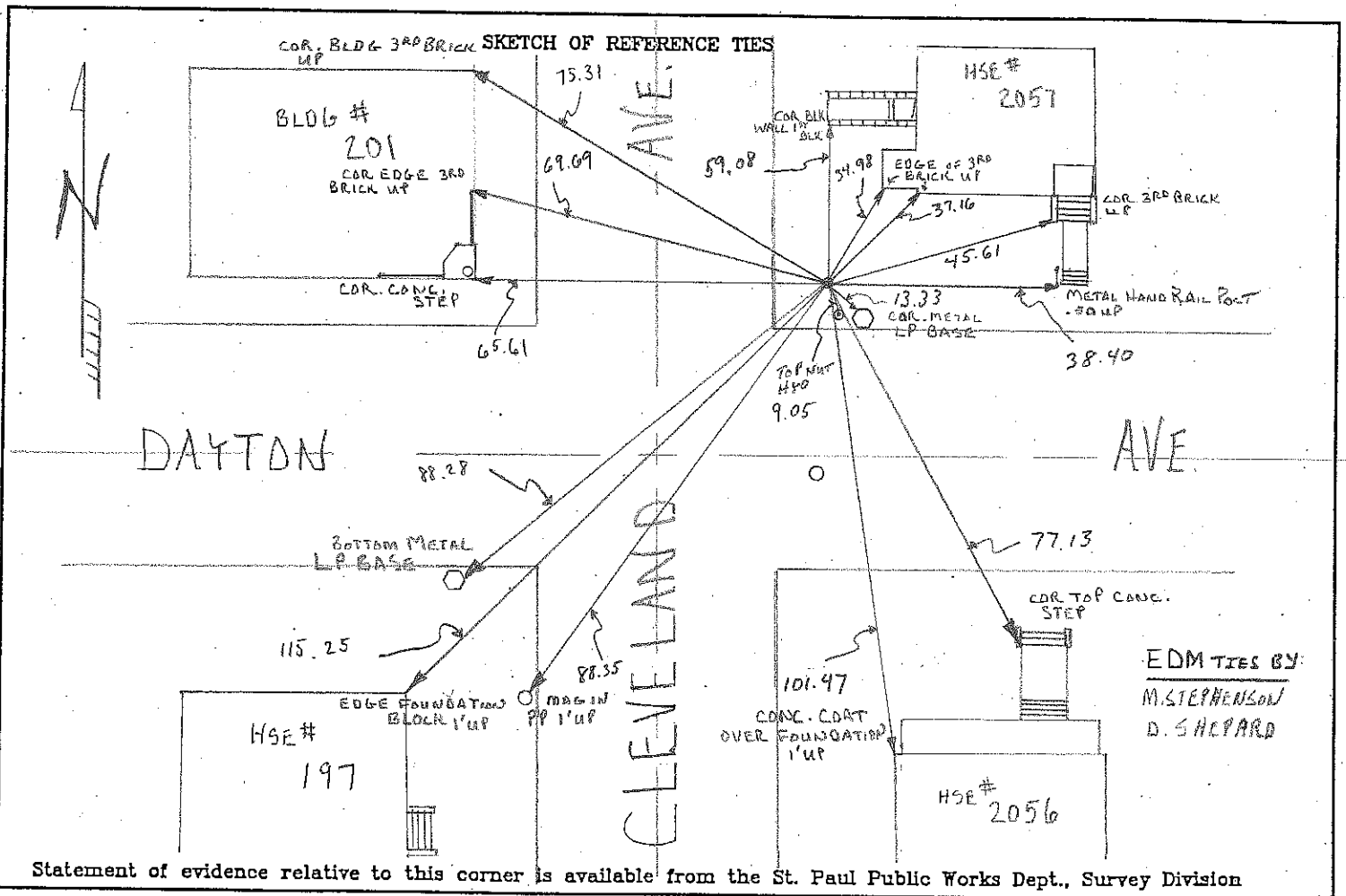

I hereby certify that this document and the data contained herein was prepared by me or under my direct supervision.

[Signature] DEC 24, 2012
SIGNATURE DATE

Registration No. 44880
 Land Surveyor County Surveyor
 Professional Engineer
 Chief Surveyor, City of St. Paul

Office of The County Recorder, County of Ramsey

I hereby certify that this document was filed in the county
Recorders office at _____ M. on the _____ day of _____

County Recorder _____
By _____, Deputy

DOCUMENT NUMBER _____