

# CERTIFICATE OF MONUMENT LOCATION

STATION  
CITY MON. NO. 3847  
OLD INDEX NO. 1521B

Corner in the SW Qtr. of Section 29 Township 29 Range 23

STATE OF MINNESOTA, County of Ramsey  
At the corner location shown on the sketch:

On 3-23-2009 found a CIM @ ASPHALT GRADE E. LINE OF  
RAYMOND AVE. @ SO. LINE LONG AVE.

left monument as found       lowered monument       removed monument (explain)

On 3-23-2009 placed NEW TIES

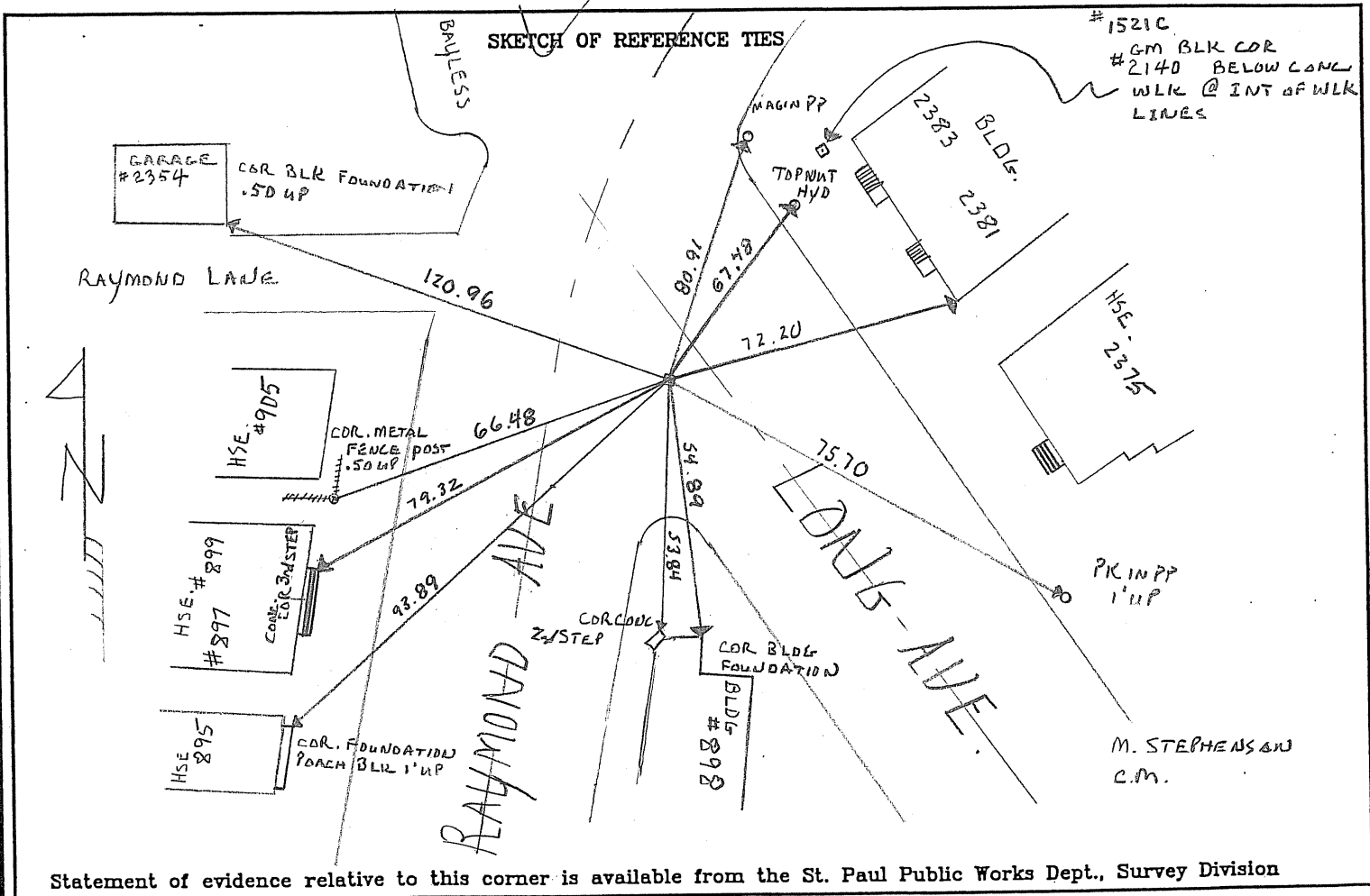

Statement of evidence relative to this corner is available from the St. Paul Public Works Dept., Survey Division

I hereby certify that this document and the data contained herein was prepared by me or under my direct supervision.

[Signature]      OCT 9 2009  
SIGNATURE      DATE  
Registration No. 44880

- Land Surveyor       County Surveyor  
 Professional Engineer  
 Chief Surveyor, City of St. Paul

Office of The County Recorder, County of Ramsey

I hereby certify that this document was filed in the county  
Recorders office at \_\_\_\_\_ M. on the \_\_\_\_\_ day of \_\_\_\_\_

County Recorder \_\_\_\_\_  
By \_\_\_\_\_, Deputy

DOCUMENT NUMBER \_\_\_\_\_