

CERTIFICATE OF MONUMENT LOCATION

CITY MON. NO. 3869

OLD INDEX NO. 2474

GM BLK Corner in the NW Qtr. of Section 9 Township 28N Range 23W

STATE OF MINNESOTA, County of Ramsey

At the corner location shown on the sketch:

On 8-18-2011 found a GM BLK CORNER REMOVED BY SIDEWALK

date

CONSTRUCTION / WILL REPLACE GM

- left monument as found
 lowered monument
 removed monument (explain)

On 8-26-2011 placed a GM BACK IN POSITION FROM FIELD TIES - PHOTOS

date

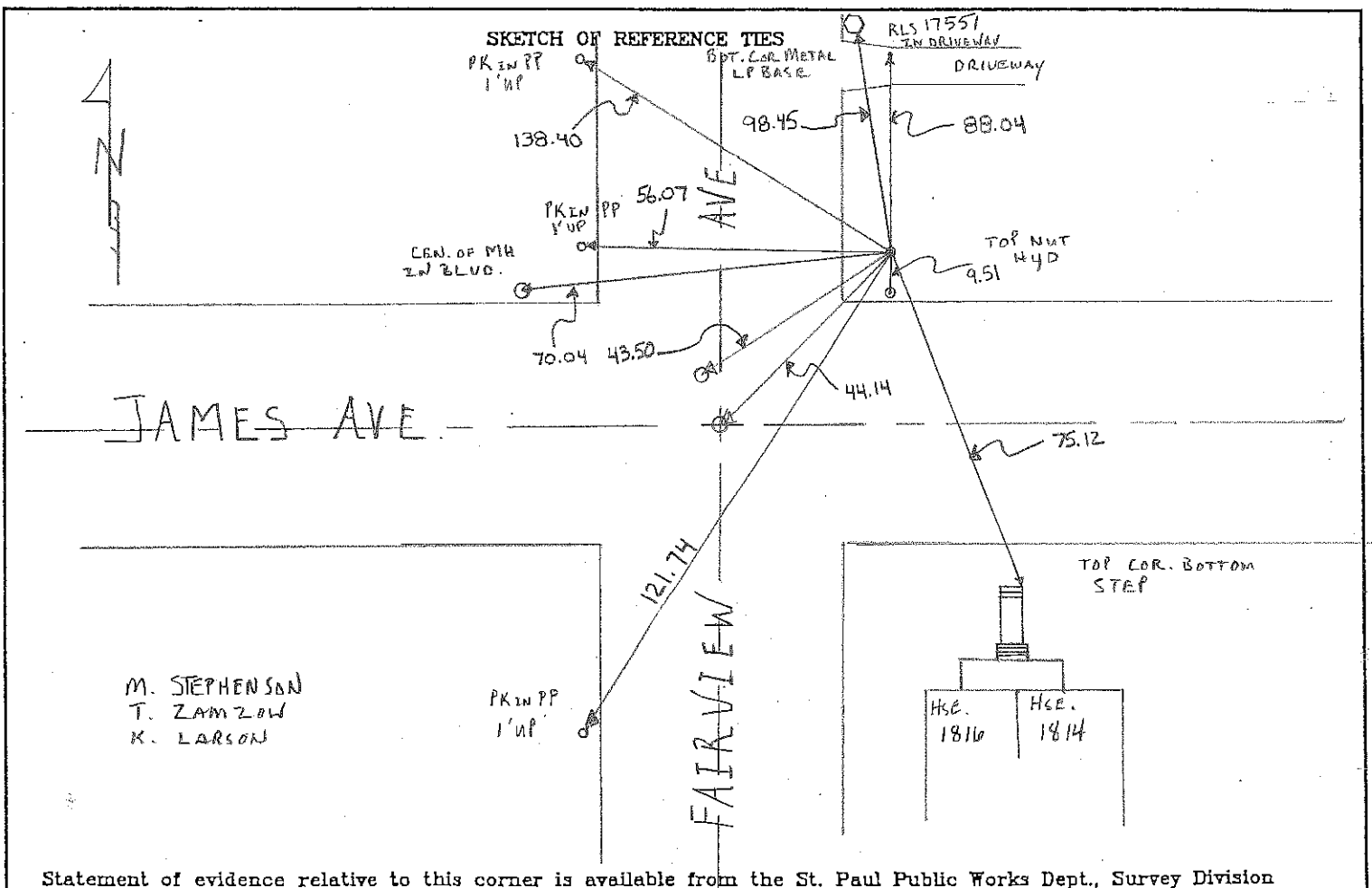

M. STEPHENSON
T. ZAMZOW
K. LARSON

PK IN PP
1' W/PP

Statement of evidence relative to this corner is available from the St. Paul Public Works Dept., Survey Division

I hereby certify that this document and the data contained herein was prepared by me or under my direct supervision.

[Signature] Aug 17, 2012
SIGNATURE DATE

Registration No. 44880

- Land Surveyor County Surveyor
 Professional Engineer
 Chief Surveyor, City of St. Paul

Office of The County Recorder, County of Ramsey.

I hereby certify that this document was filed in the county Recorders office at _____ M. on the _____ day of _____

County Recorder _____

By _____, Deputy

DOCUMENT NUMBER _____

SCANNED ON 7/4/12 BY DP