

# CERTIFICATE OF MONUMENT LOCATION

CITY MON. NO. 3876

OLD INDEX NO. 2382

BLK Corner in the SE Qtr. of Section 20 Township 29 Range 23

STATE OF MINNESOTA, County of Ramsey

At the corner location shown on the sketch:

On APRIL 2009 found a GM BLK COR .62 BELOW SIDEWALK GRADE

NEC CARTER + RAYMOND AVE 5' N. OF N. CARTER WALK LINE

- left monument as found       lowered monument       removed monument (explain)

On APRIL 2009 placed TIES, PHOTOS, GPS

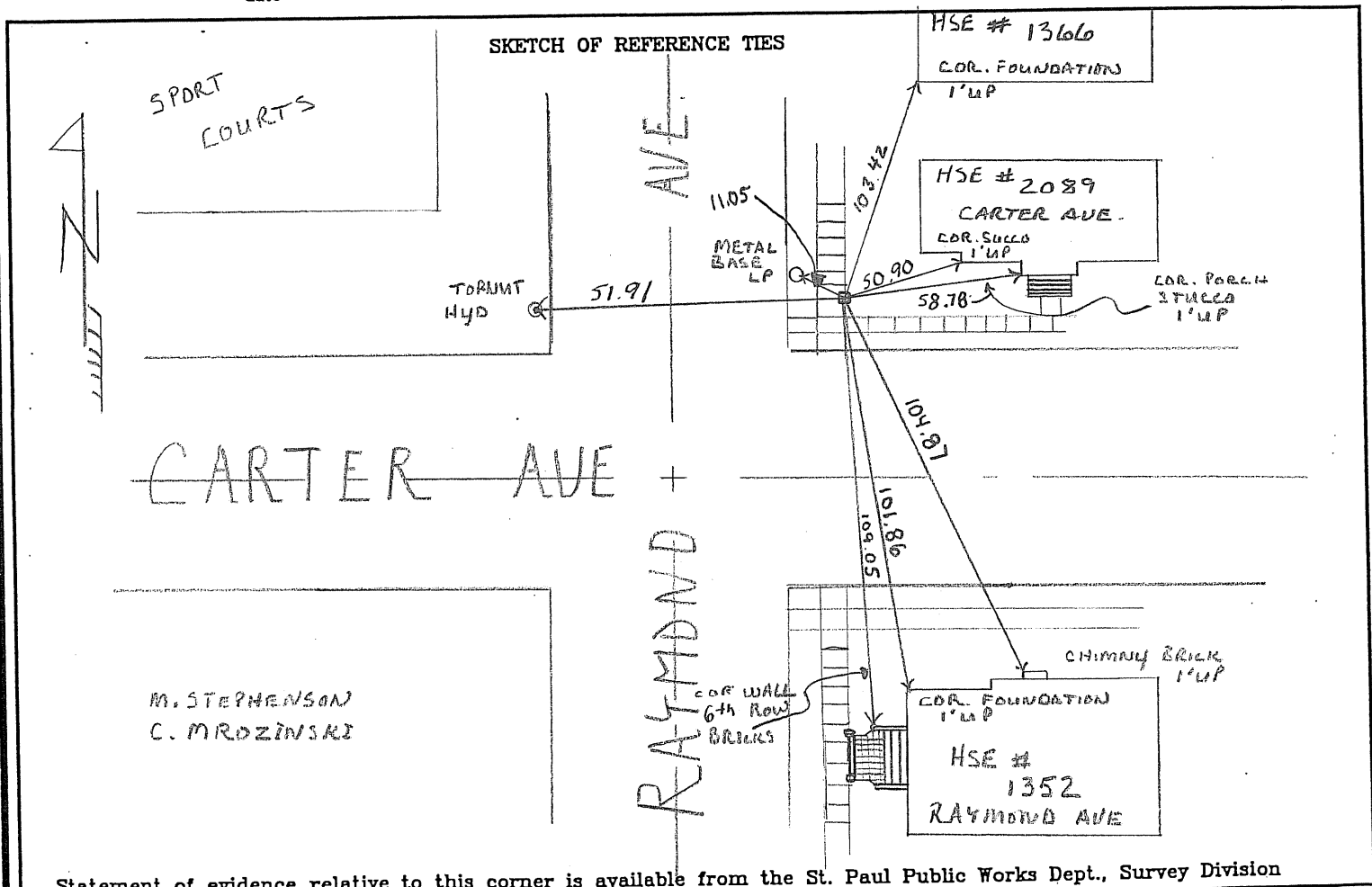

Statement of evidence relative to this corner is available from the St. Paul Public Works Dept., Survey Division

I hereby certify that this document and the data contained herein was prepared by me or under my direct supervision.

SIGNATURE

DATE

Registration No. 44880

- Land Surveyor       County Surveyor  
 Professional Engineer  
 Chief Surveyor, City of St. Paul

Office of The County Recorder, County of Ramsey

I hereby certify that this document was filed in the county

Recorders office at \_\_\_\_\_ M. on the \_\_\_\_\_ day of \_\_\_\_\_

County Recorder \_\_\_\_\_

By \_\_\_\_\_, Deputy

DOCUMENT NUMBER \_\_\_\_\_