

CERTIFICATE OF MONUMENT LOCATION

CITY MON. NO. 5671OLD INDEX NO. 2027BLK Corner in the NE Qtr. of Section 25 Township 29N Range 23W

STATE OF MINNESOTA, County of Ramsey

At the corner location shown on the sketch:

On MARCH 3, 2010 found a GM BLK COR NWC RICE ST AND
date
ROSE AVE. .35 BELOW SIDEWALK GRADE☒ left monument as found ☐ lowered monument ☐ removed monument (explain)On MARCH 3, 2010 placed a GPS- PHOTOS- TIES
date

SKETCH OF REFERENCE TIES

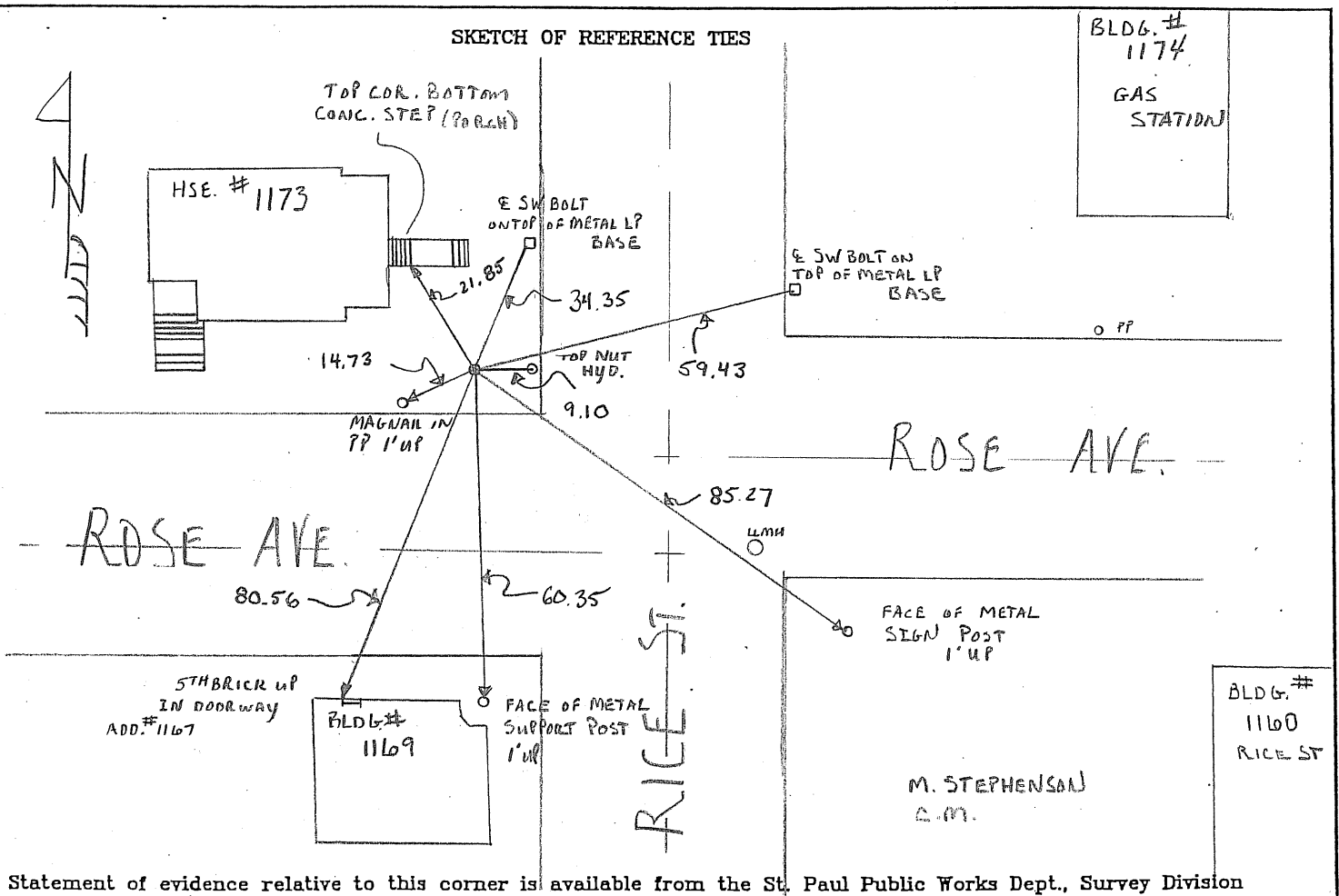

Statement of evidence relative to this corner is available from the St. Paul Public Works Dept., Survey Division

I hereby certify that this document and the data contained herein was prepared by me or under my direct supervision.

Office of The County Recorder, County of Ramsey

I hereby certify that this document was filed in the county

Recorders office at _____ M. on the _____ day of _____

County Recorder _____

By _____, Deputy

DOCUMENT NUMBER _____

SIGNATURE

DATE

Registration No.

44880

- ☐ Land Surveyor ☐ County Surveyor
☐ Professional Engineer
☒ Chief Surveyor, City of St. Paul