

CERTIFICATE OF MONUMENT LOCATION

CITY MON. NO. 5765

OLD INDEX NO. 2126

BLK Corner in the SE Qtr. of Section 33 Township 29N Range 23W

STATE OF MINNESOTA, County of Ramsey
At the corner location shown on the sketch:

On MARCH 10, 2010 found a GM BLK COR NW/4 SHIELDS AVE
date
WHEELER ST. .35 BELOW SIDEWALK GRADE (GM UNDER CONC. BLOCK EASY TO REMOVE)

- left monument as found lowered monument removed monument (explain)

On MARCH 15, 2010 placed a GPS - PHOTOS - TIES
date

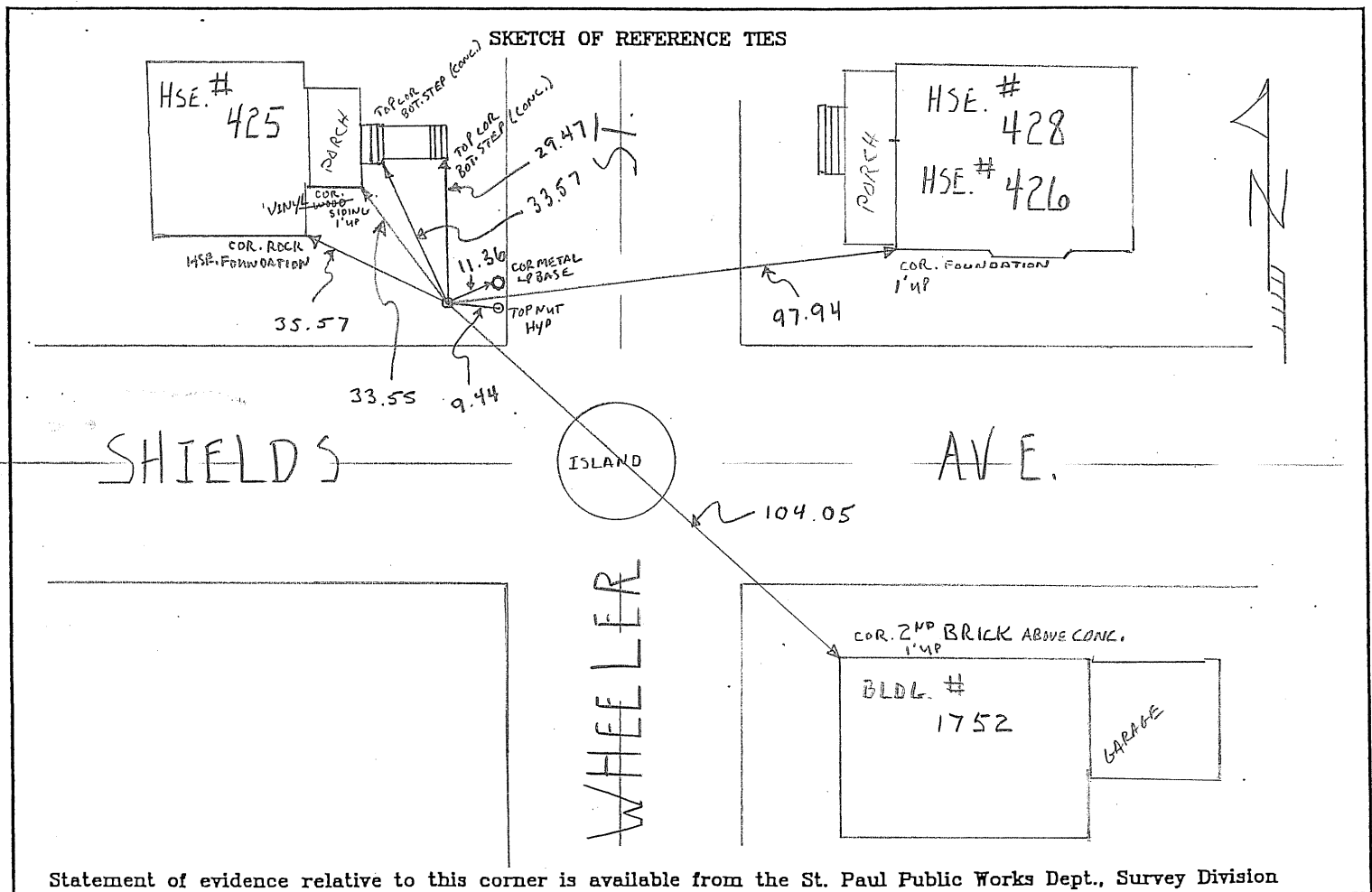

Statement of evidence relative to this corner is available from the St. Paul Public Works Dept., Survey Division

I hereby certify that this document and the data contained herein was prepared by me or under my direct supervision.

[Signature] MAY 13, 2016
SIGNATURE DATE

- Registration No. 44880
- Land Surveyor County Surveyor
- Professional Engineer
- Chief Surveyor, City of St. Paul

Office of The County Recorder, County of Ramsey

I hereby certify that this document was filed in the county
 Recorders office at _____ M. on the _____ day of _____

County Recorder _____

By _____, Deputy

DOCUMENT NUMBER _____