

CERTIFICATE OF MONUMENT LOCATION

CITY MON. NO. 5767

OLD INDEX NO. 2128

BLK Corner in the SE Qtr. of Section 33 Township 29N Range 23W

STATE OF MINNESOTA, County of Ramsey

At the corner location shown on the sketch:

On MARCH 5TH 2010 found a GM BLK COR NEC BEACON AVE. 1

date

ST. ANTHONY AVE. .40 BELOW SIDEWALK GRADE (NOTE: GM IS 1.60' UNDER BLOCK WALL, SE COR. NEW WALL LINES UP WITH CENTER FACE OF FRONT.

- left monument as found lowered monument removed monument (explain)

On MARCH 5TH 2010 placed a GPS - PHOTOS - TIES

date

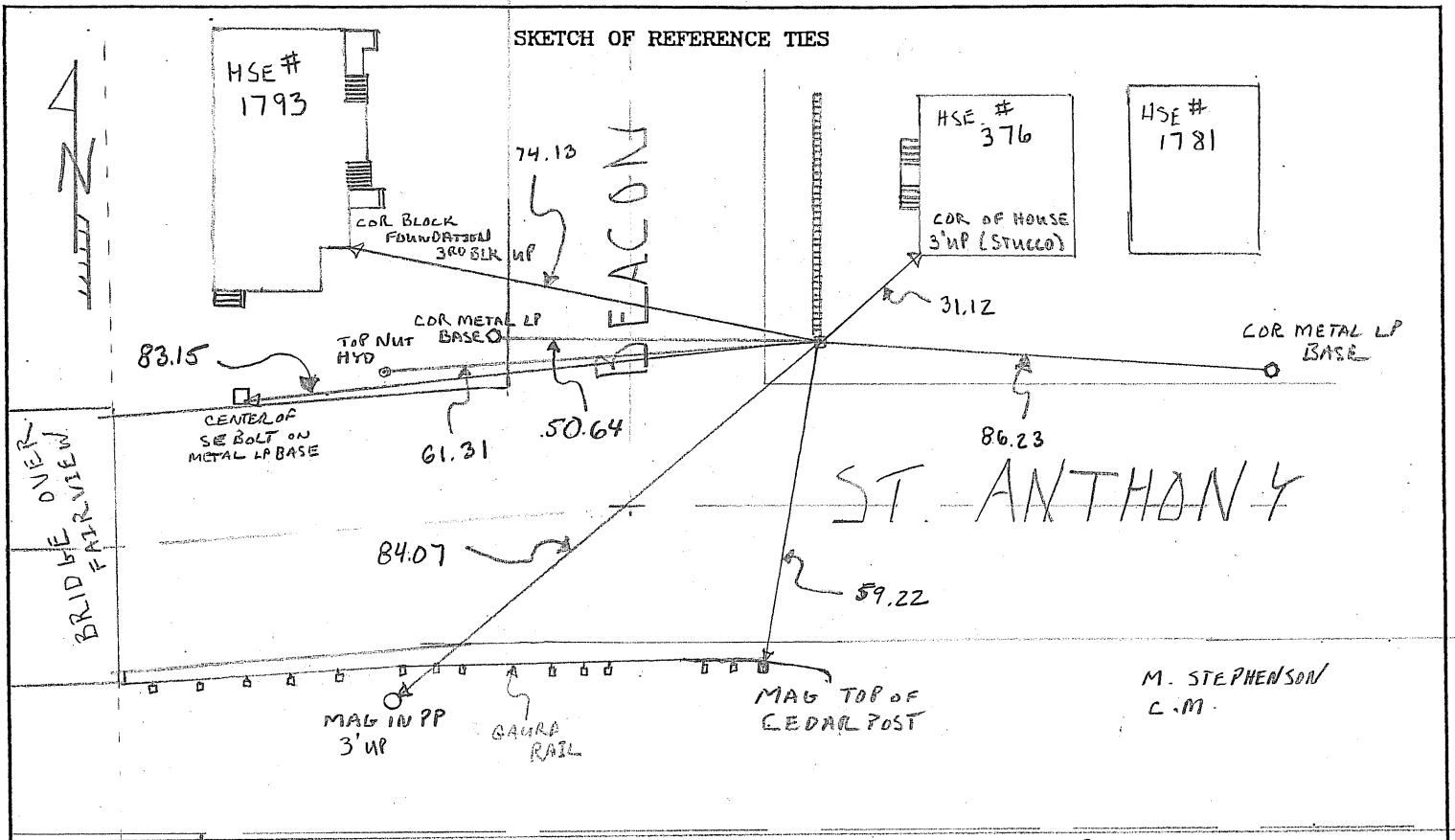

RR BRIDGE / RR

I 94
Statement of evidence relative to this corner is available from the St. Paul Public Works Dept., Survey Division

I hereby certify that this document and the data contained herein was prepared by me or under my direct supervision.

[Signature] MARCH 16, 2010
SIGNATURE DATE

Registration No. 44880

- Land Surveyor County Surveyor
 Professional Engineer
 Chief Surveyor, City of St. Paul

Office of The County Recorder, County of Ramsey

I hereby certify that this document was filed in the county
Recorders office at _____ M. on the _____ day of _____

County Recorder _____

By _____, Deputy

DOCUMENT NUMBER _____