

CERTIFICATE OF MONUMENT LOCATION

CITY MON. NO. 6132

OLD INDEX NO. 2610

END OF RAD Corner in the SW Qtr. of Section 28 Township 29 Range 23

STATE OF MINNESOTA, County of Ramsey

At the corner location shown on the sketch:

On MAY 17, 2012 found a GM .60 BELOW SIDEWALK GRADE 100' +/- WEST

date

OF CLAYLAND & SO. WALK LINE CHELTON AVE.

- left monument as found
- lowered monument
- removed monument (explain)

On Nov. 6, 2012 placed TIES & PHOTOS

date

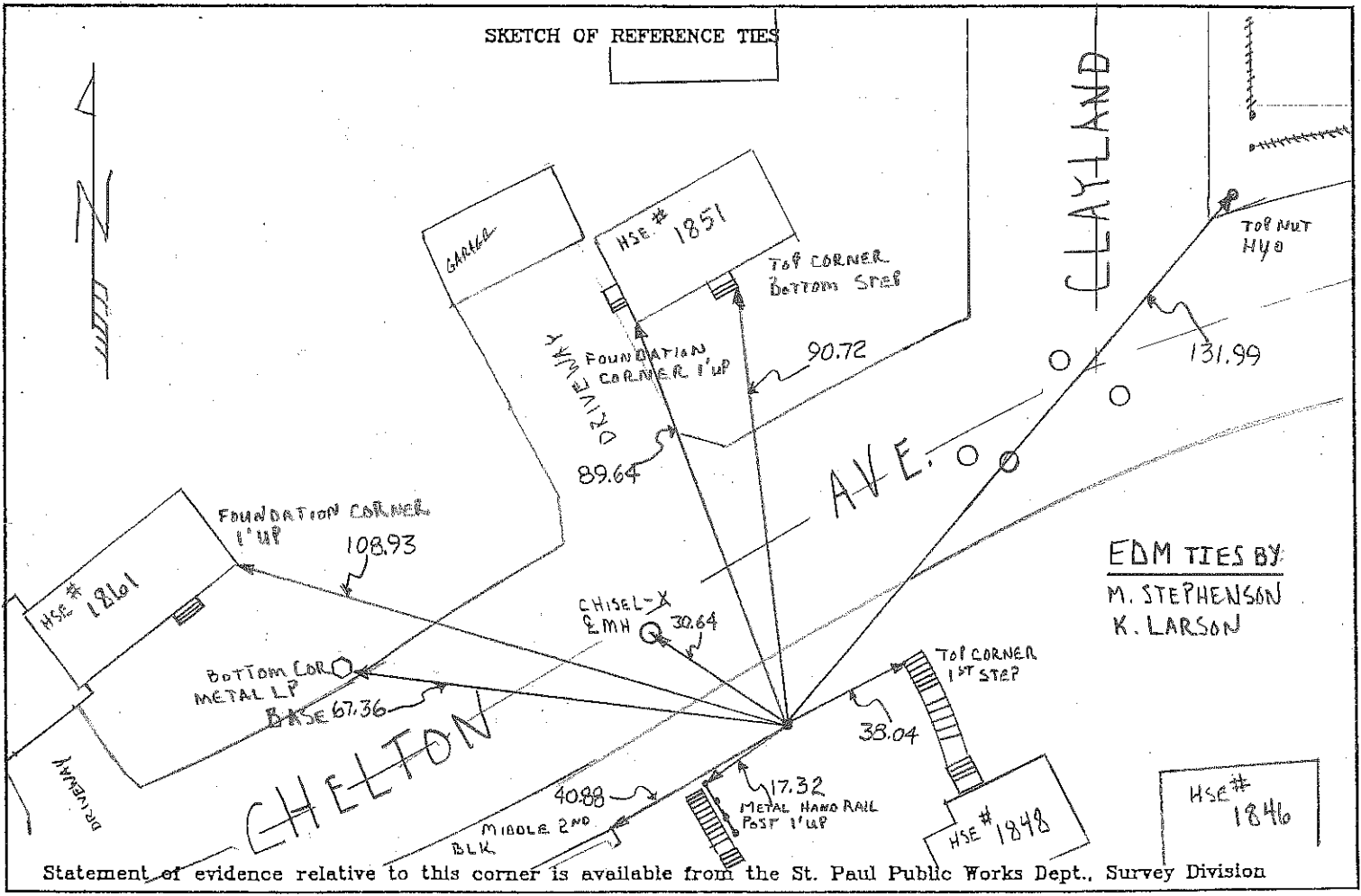

I hereby certify that this document and the data contained herein was prepared by me or under my direct supervision.

[Signature] Dec 24, 2012
SIGNATURE DATE

Registration No. 44880

- Land Surveyor
- County Surveyor
- Professional Engineer
- Chief Surveyor, City of St. Paul

Office of The County Recorder, County of Ramsey

I hereby certify that this document was filed in the county Recorders office at _____ M. on the _____ day of _____

County Recorder _____

By _____, Deputy

DOCUMENT NUMBER _____