

# CERTIFICATE OF MONUMENT LOCATION

CITY MON. NO. 6361

OLD INDEX NO. 2886

BLK Corner in the SW Qtr. of Section 28 Township 29 Range 23

STATE OF MINNESOTA, County of Ramsey  
At the corner location shown on the sketch:

On JUNE 4, 2012 found a GM NEC. CHELTON & HOWELL .35 BELOW SIDEWALK  
date

GRADE

- left monument as found
- lowered monument
- removed monument (explain)

On JUNE 4<sup>TH</sup> 2012 placed PLACED TIES - PHOTOS  
date

SKETCH OF REFERENCE TIES

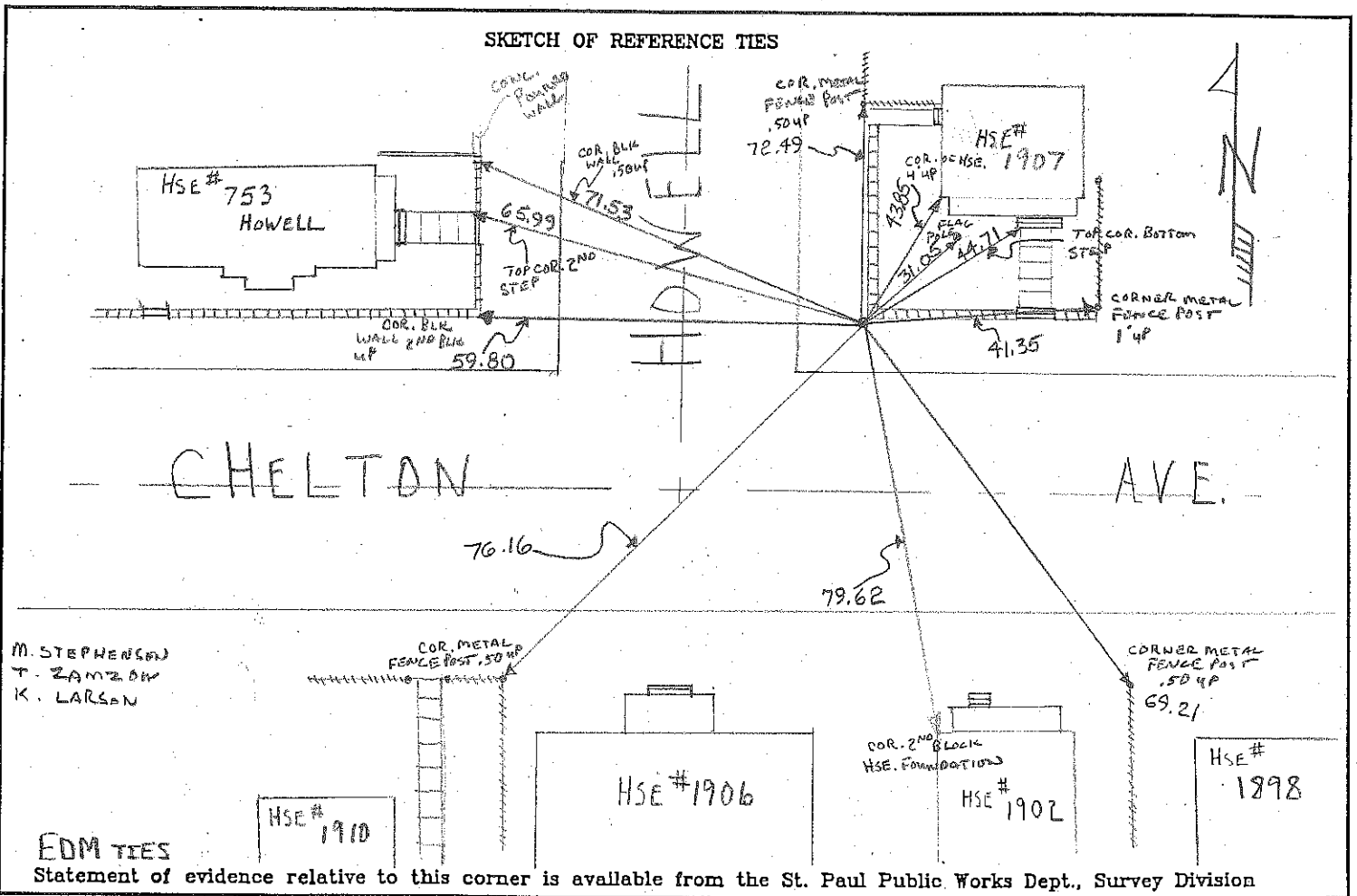

M. STEPHENSON  
T. ZAMZOW  
K. LARSON

EDM TIES

Statement of evidence relative to this corner is available from the St. Paul Public Works Dept., Survey Division

I hereby certify that this document and the data contained herein was prepared by me or under my direct supervision.

[Signature]  
SIGNATURE  
DATE Dec 24, 2012

- Registration No. 44880
- Land Surveyor
  - Professional Engineer
  - Chief Surveyor, City of St. Paul
  - County Surveyor

Office of The County Recorder, County of Ramsey

I hereby certify that this document was filed in the county  
Recorders office at \_\_\_\_\_ M. on the \_\_\_\_\_ day of \_\_\_\_\_

County Recorder \_\_\_\_\_  
By \_\_\_\_\_, Deputy  
DOCUMENT NUMBER \_\_\_\_\_