

CERTIFICATE OF MONUMENT LOCATION

CITY MON. NO. 6778

OLD INDEX NO. 50

GM BLK Corner in the SW Qtr. of Section 28 Township 29 Range 23

STATE OF MINNESOTA, County of Ramsey
At the corner location shown on the sketch:

On _____ found a GM BLOCK CORNER @ SIDEWALK GRADE
date
SEC TATUM ST. & TAYLOR AVE.

- left monument as found
- lowered monument
- removed monument (explain)

On 11-7-2012 placed TIES - PHOTOS
date

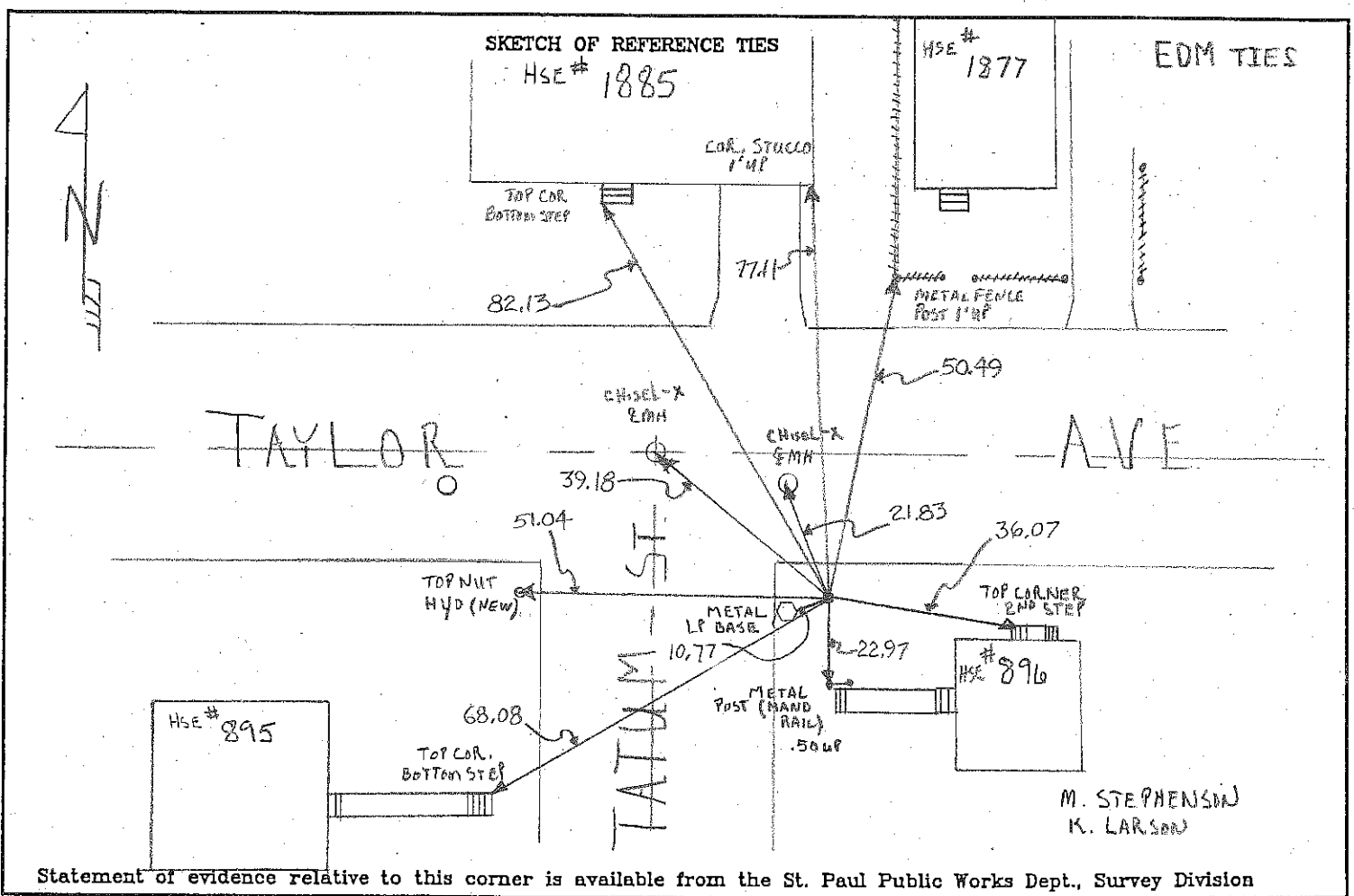

Statement of evidence relative to this corner is available from the St. Paul Public Works Dept., Survey Division

I hereby certify that this document and the data contained herein was prepared by me or under my direct supervision.

[Signature]
 SIGNATURE
44880
 REGISTRATION NO.
Dec 24, 2012
 DATE

- Land Surveyor
- County Surveyor
- Professional Engineer
- Chief Surveyor, City of St. Paul

Office of The County Recorder, County of Ramsey

I hereby certify that this document was filed in the county
Recorders office at _____ M. on the _____ day of _____

County Recorder _____
By _____, Deputy

DOCUMENT NUMBER _____